

# M702 & M703 TALLY LED Definition

## 1. PIN Definition:

(the first pin is at the right end)

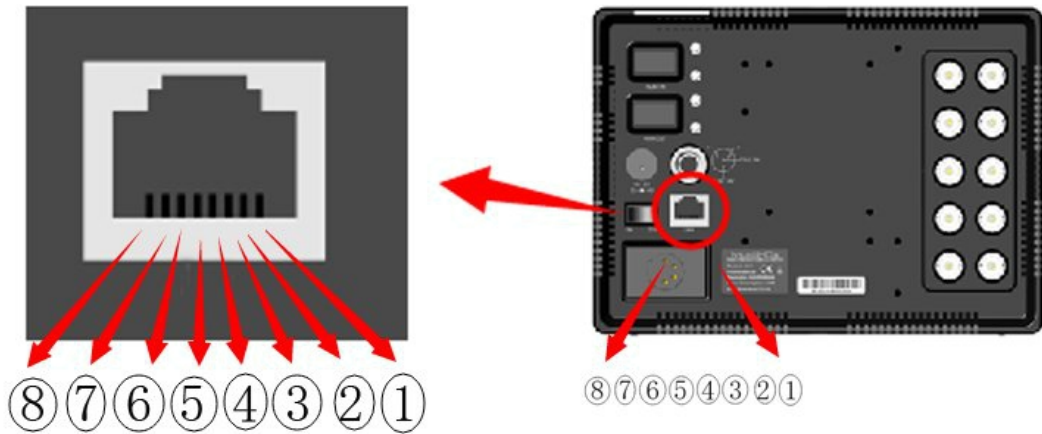

## 2. Connection definition:

SN	PIN								LED Status
	①	②	③	④	⑤	⑥	⑦	⑧	
1	GND	NC	NC	NC	NC	NC	NC	GND	ALL IN YELLOW
2	NC	GND	NC	NC	NC	NC	NC	GND	ALL IN RED
3	NC	NC	GND	NC	NC	NC	NC	GND	ALL IN GREEN

Note: NC is no connection.

Quick connection:

1. PIN#1 connected with PIN#8, yellow on
2. PIN#2 connected with PIN#8, red on
3. PIN#3 connected with PIN#8, green on